

RoHS

RD-1

■ Specifications :

- Voltage rating: 125V AC / DC
- Current rating: 3A AC / DC
- Withstanding voltage: 500V AC/minute
- Temperature range: -40°C~+125°C
- Insulation resistance:  $\geq 1000M\Omega$
- Contact resistance:  $\leq 10m\Omega$
- After environmental testing:  $\leq 20m\Omega$
- Suitable GYA Terminal: 2022T
- Suitable GYA Header: 2008W

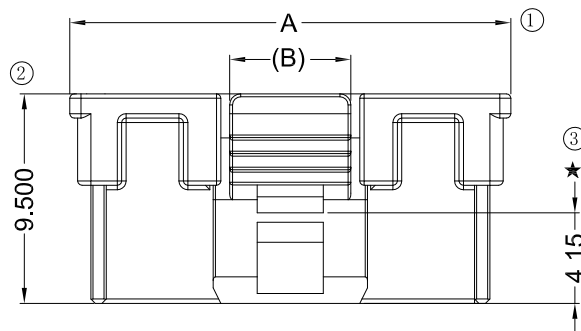

03~15P Shape

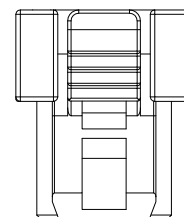

02P Shape  
A View

2022H -XX -PTBK  
① ② ③ ④ ⑤

- ① Series No.  
② Category: H-HOUSING  
③ Row No.-Pin No: XX-02~15 Pin  
④ Plastic material: PT- PBT+GF UL 94-V0  
⑤ Color: BK-Black

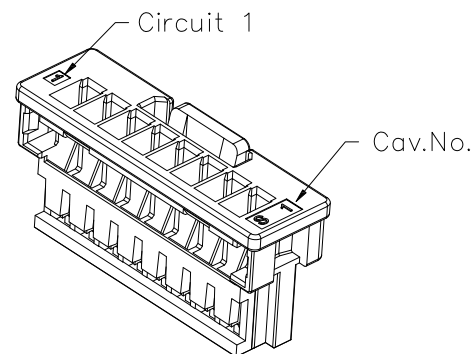
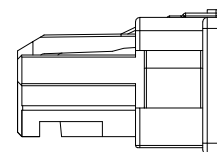
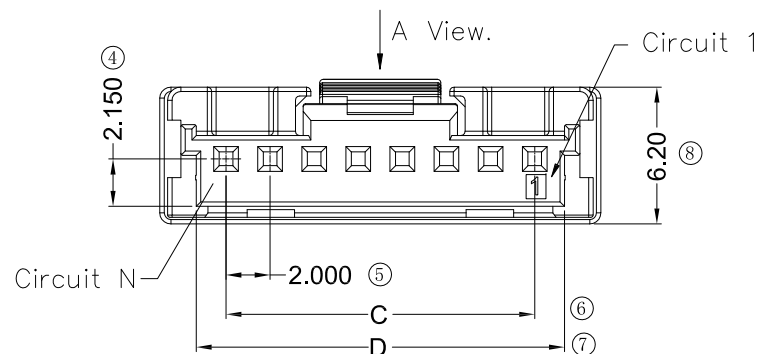

Poles	Dimensions (mm)			
	A	B	C	D
02	8.00	3.30	2.00	4.70
03	10.00	3.50	4.00	6.70
04	12.00	5.50	6.00	8.70
05	14.00	5.50	8.00	10.70
06	16.00	5.50	10.00	12.70
07	18.00	5.50	12.00	14.70
08	20.00	5.50	14.00	16.70
09	22.00	5.50	16.00	18.70
10	24.00	5.50	18.00	20.70
11	26.00	5.50	20.00	22.70
12	28.00	5.50	22.00	24.70
13	30.00	5.50	24.00	26.70
14	32.00	5.50	26.00	28.70
15	34.00	5.50	28.00	30.70



GENERAL TOLERANCE				PART NO.			
.X	±0.30	<b>GYA</b> 东莞市国亚电子有限公司 Connectors Dong Guan Guo Ya Connectors co., ltd.		2022H- XX-PTBK			
.XX	±0.20			TITLE			
.XXX	±0.10			2.00mm Pitch WTB Conn. Housing With TPA Feature			
X.°	±1°			UNIT	SCALE	SHEET	REV
PROJECT	Yangzhengguo	Yangzhengyi	Lvtiansheng	mm	3:1	1/1	A0
DATE	REV	ECN ON.	DESCRIPTION	MODIFY	APPROVAL	DATE	NUMBER
1							XXXX
2							
3							
4							
5							
6							
7							
8							

RoHS

RD-1

Specifications :

- Voltage rating: 125V AC / DC
- Current rating: 3A AC / DC
- Withstanding voltage: 500V AC/minute
- Temperature range: -40°C~+125°C
- Insulation resistance:  $\geq 1000M\Omega$
- Contact resistance:  $\leq 10m\Omega$
- After environmental testing:  $\leq 20m\Omega$
- Suitable GYA Terminal: 2022T
- Suitable GYA Header: 2008W

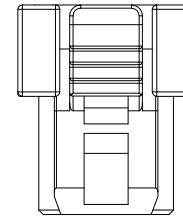
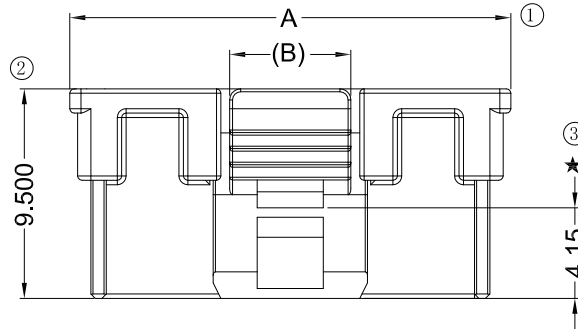

02P Shape  
A View

A2022 -XX -PTBK  
① ② ③ ④ ⑤

- ① Assembled semi-finished product  
② Series No.  
③ Row No.-Pin No: XX-02~15Pin  
④ Housing plastic material: PT- PBT+GF UL 94-V0  
⑤ Color: BK-Black

Poles	Dimensions (mm)			
	A	B	C	D
02	8.00	3.30	2.00	4.70
03	10.00	3.50	4.00	6.70
04	12.00	5.50	6.00	8.70
05	14.00	5.50	8.00	10.70
06	16.00	5.50	10.00	12.70
07	18.00	5.50	12.00	14.70
08	20.00	5.50	14.00	16.70
09	22.00	5.50	16.00	18.70
10	24.00	5.50	18.00	20.70
11	26.00	5.50	20.00	22.70
12	28.00	5.50	22.00	24.70
13	30.00	5.50	24.00	26.70
14	32.00	5.50	26.00	28.70
15	34.00	5.50	28.00	30.70

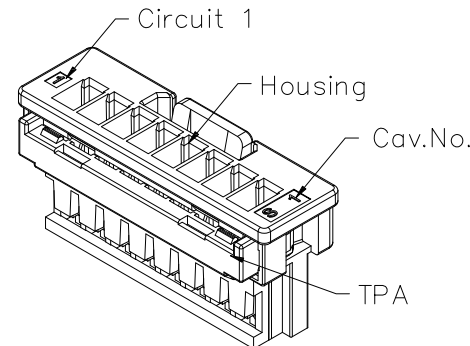
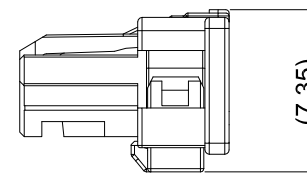
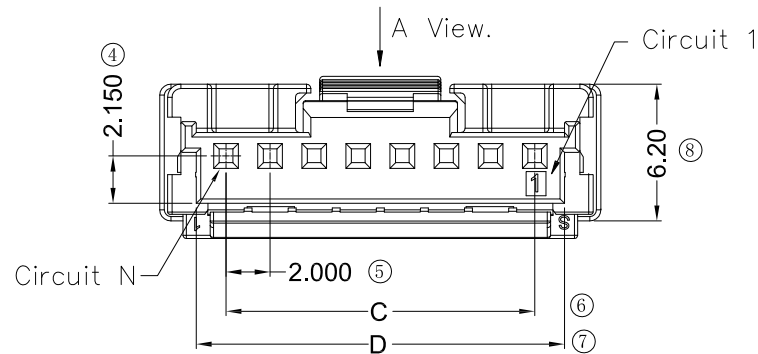

Housing	2022H -XX -PTBK	PBT+GF	1
TPA	C2022-XX-XXNC	PA4T+GF or PBT+GF	1
Description	P/N	Material	Quantity

DATE	REV	ECN ON.	DESCRIPTION	MODIFY	APPROVAL
1					
2					
3					
4					

GENERAL TOLERANCE	
.X	$\pm 0.30$
.XX	$\pm 0.20$
.XXX	$\pm 0.10$
X. <sup>o</sup>	$\pm 1^{\circ}$
PROJECT	

**GYA**  
Connectors

东莞市国亚电子有限公司  
Dong Guan Guo Ya Connectors co., ltd.

APPROVAL	CHECK	DRAWN	DATE
Yangzhengguo	Yangzhengyi	Lvtiansheng	2016/08/26

PART NO.				
A2022- XX-PTBK				
TITLE				
2.00mm Pitch WTB Conn. Housing With TPA				
UNIT	SCALE	SHEET	REV	NUMBER
mm	3:1	1/1	A0	XXXX

## RoHS

RD-1

■ Specifications :

- Voltage rating: 125V AC / DC
- Current rating: 3A AC / DC
- Withstanding voltage: 500V AC/minute
- Temperature range: -40°C~+125°C
- Insulation resistance:  $\geq 1000M\Omega$
- Contact resistance:  $\leq 10m\Omega$
- After environmental testing:  $\leq 20m\Omega$
- Suitable GYA Terminal: 2022T
- Suitable GYA Housing: 2022H
- Suitable GYA Header: 2008W

C2022-XX -XXNC

①
②
③
④

① Series No.

② Row No.-Pin No: XX-02~15Pin

③ Plastic material: PT- PBT+GF  
4T-PA4T+GF

④ Color: NC—Natural Color

Poles	Dimensions (mm)			Poles	Dimensions (mm)		
	AB		CC		AB		
02	5.10	6.70	7.10	09	18.50	19.90	20.40
03	6.40	8.00	8.40	10	20.50	21.90	22.40
04	8.40	10.00	10.40	11	22.50	23.90	24.40
05	10.50	11.90	12.40	12	24.50	25.90	26.40
06	12.50	13.90	14.40	13	26.50	27.90	28.40
07	14.50	15.90	16.40	14	28.50	29.90	30.40
08	16.50	17.90	18.40	15	30.50	31.90	32.40

						GENERAL TOLERANCE	<div><div><div>GYA</div><div>Connectors</div></div><div>东莞市国亚电子有限公司 Dong Guan Guo Ya Connectors co., ltd.</div></div>				PART NO. C2022-XX-XXNC				
						.X ±0.30					TITLE 2.00mm Pitch WTB Conn. TPA				
						.XX ±0.20	APPROVAL	CHECK	DRAWN	DATE	UNIT	SCALE	SHEET	REV	NUMBER
						.XXX ±0.10					mm	4:1	1/1	A0	XXXX
						X.° ±2°									
DATE	REV	ECN ON.	DESCRIPTION	MODIFY	APPROVAL	<div>PROJECT</div> <div></div>	Yangzhengguo	Yangzhengyi	Lvtiansheng	2016/08/26					

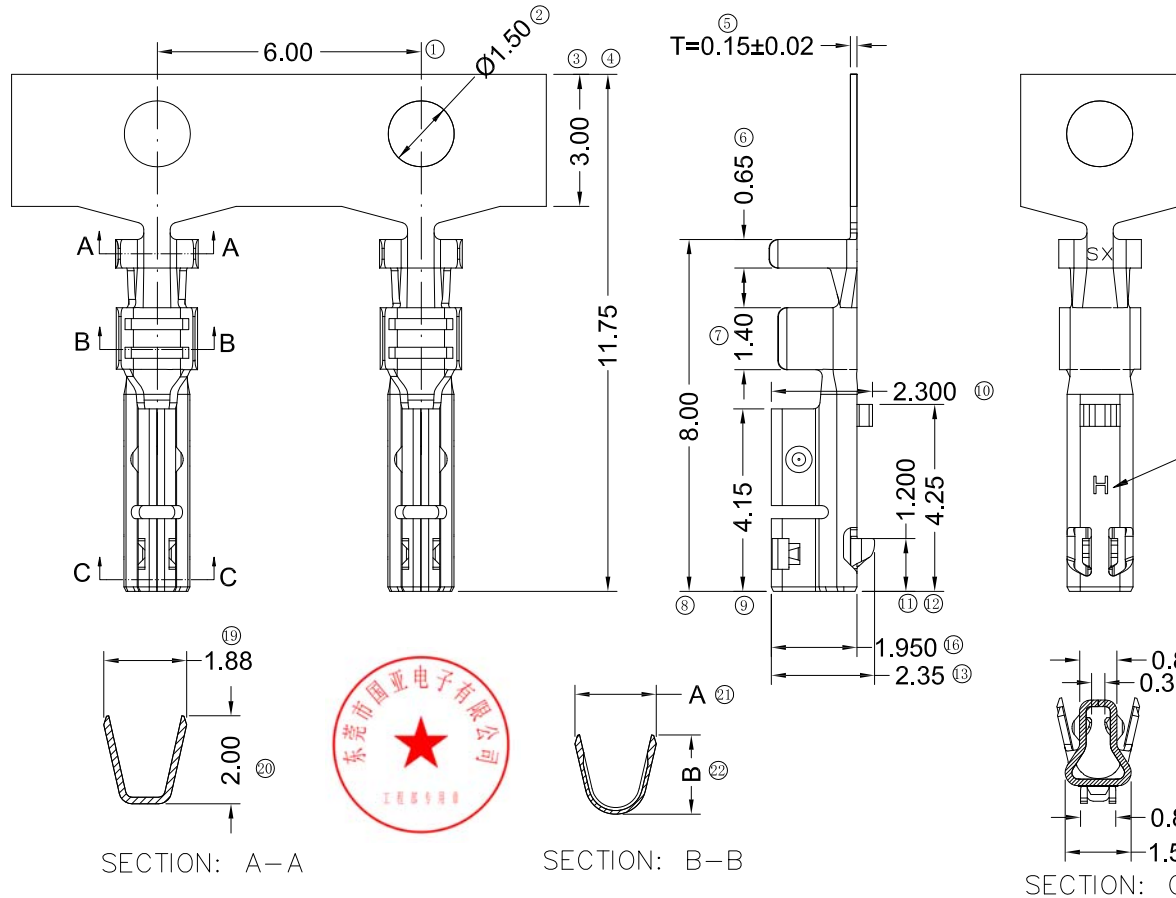

## ■ Specification:

- Voltage rating: 125V AC / DC
- Current rating: 3A AC / DC
- Withstanding voltage: 500V AC/minute
- Temperature range:
  - 40°C~+105°C(Phosphor Bronze)
  - 40°C~+125°C(C7025)
- Insulation resistance:  $\geq 1000M\Omega$
- Contact resistance:  $\leq 10m\Omega$
- After environmental testing:  $\leq 20m\Omega$

Material mark

H-C7025

Blank(no mark)-Phosphor bronze

2022 T X - X SN1  
① ② ③ ④ ⑤

① Series Number: 2021

② Category: T - Terminal

③ Shape: Blank-Low Barrel ; H-High Barrel

④ Material: P - Phosphor bronze

H-C7025

⑤ Plating code: see table 1

SECTION: C-C

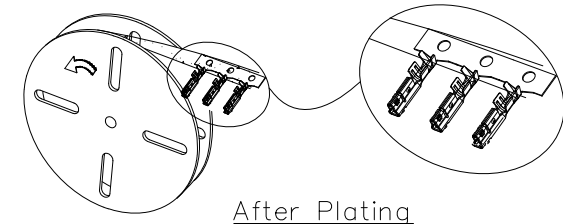

Table 1

20221TH-HSN1	AWG#20~22 (0.35~0.5mm <sup>2</sup> )	Ø1.6mm Max	Underplate: Ni 40~120u" (1~3um) overall Top plating: Sn 80~200u" (2~5um) overall	2022H	1.85	1.80
2022TH-PSN1					1.25	1.35
2022T-HSN1	AWG#24~26 (0.22~0.13mm <sup>2</sup> )					
2022T-PSN1						
P/N	Wire Range	Insulation O.D.	Finish	Suitable GYA Housing	Dim A	Dim B

## GENERAL TOLERANCE

.X ±0.30

.XX ±0.20

.XXX ±0.10

X.° ±1°

## PROJECT

PROJECT

**GYA**  
Connectors

东莞市国亚电子有限公司

Dong Guan Guo Ya Connectors co., ltd.

APPROVAL

CHECK

DRAWN

DATE

DATE

REV

ECN ON.

DESCRIPTION

MODIFY

APPROVAL

PART NO.

2022TX-XSN1

TITLE

2.00mm Pitch WTB Conn. Terminal

UNIT

SCALE

SHEET

REV

NUMBER

mm

6:1

1/1

A0

XXXX

RoHS

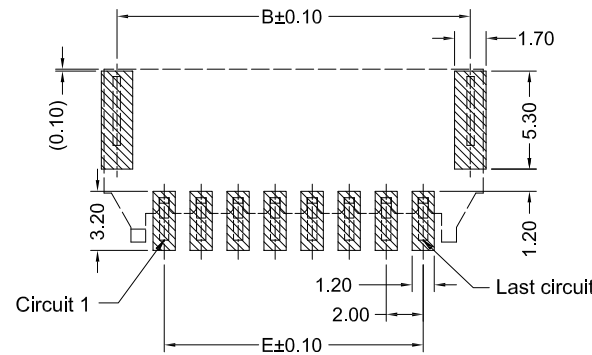
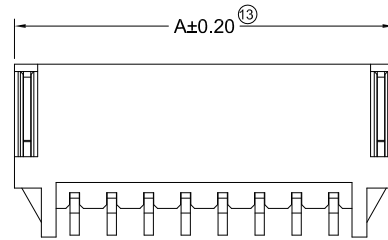
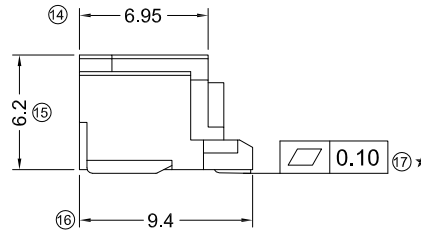
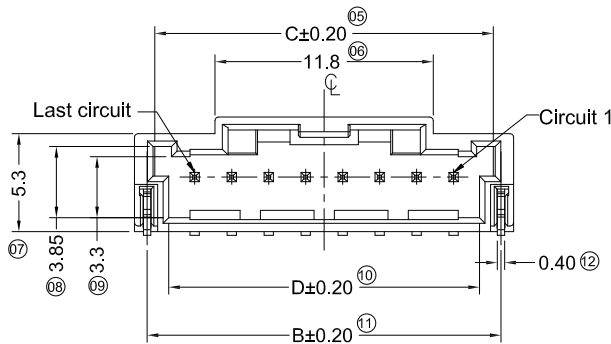
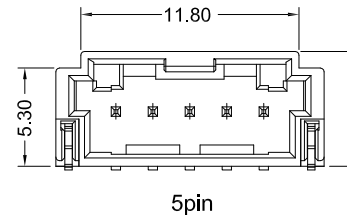
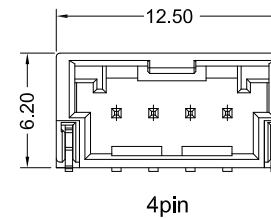
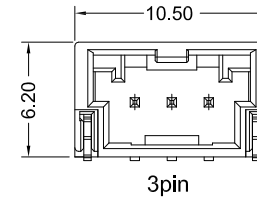
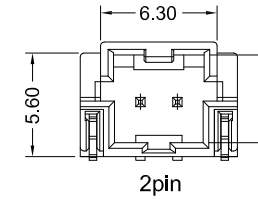
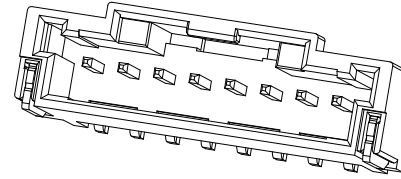
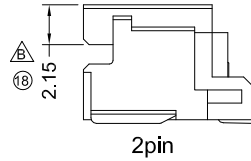
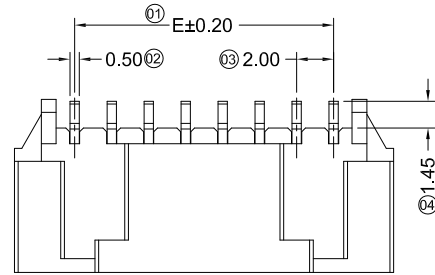

RECOMMENDED P.C.B LAYOUT  
(TOLERANCE:±0.05)

Specifications :

- Voltage rating: 125V AC / DC
- Current rating: 3A AC / DC
- Withstanding voltage: 500V AC/minute
- Temperature range: -40° ~+105°
- Insulation resistance: ≥1000MΩ
- Contact resistance: ≤10mΩ
- After environmental testing: ≤20mΩ
- Material(Pin): Brass
- Mates With GYA Housing : 2008H
- "★" Critical dimension

2008 W R S - 1 x XX - XX X B 05 R R XXX Q

① ② ③ ④ ⑤ ⑥ ⑦ ⑧ ⑨ ⑩ ⑪ ⑫ ⑬

- ① Series No.  
② Category: W-wafer  
③ Connector Type: R-Right Angle 90°  
④ Mounting Type: S-SMT  
⑤ Row No.-Pin No Per Row: 1xXX-Single Row 1xXXPin  
⑥ Plastic material: 9T- PA9T UL94V-0; LP- LCP UL94V-0  
⑦ Color: N-Natural; B-Black; R-Red; L-Blue  
⑧ Metal material: B-Brass  
⑨ Plating Code: 05-Matte Tin  
⑩ Packing: R-Reel  
⑪ RoHS/HF: H-Halogen-Free R-Rohs  
⑫ Sequence Number: 002-Coldsealing ; 02C-Heatsealing  
⑬ Special code: Q-Automotive Connectors

Poles	Dimensions (mm)				
	A	B	C	D	E
02	8.50	7.13	6.30	4.80	2.00
03	10.50	9.13	8.30	6.80	4.00
04	12.50	11.13	10.30	8.80	6.00
05	14.50	13.13	12.30	10.80	8.00
06	16.50	15.13	14.30	12.80	10.00
07	18.50	17.13	16.30	14.80	12.00
08	20.50	19.13	18.30	16.80	14.00
09	22.50	21.13	20.30	18.80	16.00
10	24.50	23.13	22.30	20.80	18.00
11	26.50	25.13	24.30	22.80	20.00
12	28.50	27.13	26.30	24.80	22.00
13	30.50	29.13	28.30	26.80	24.00
14	32.50	31.13	30.30	28.80	26.00
15	34.50	33.13	32.30	30.80	28.00

GENERAL TOLERANCE

.X ±0.30

.XX ±0.20

.XXX ±0.10

X.° ±2°

PROJECT



东莞市国亚电子有限公司  
Dong Guan Guo Ya Connectors co., ltd.

APPROVAL

CHECK

DRAWN

DATE

Yangzhengguo

Yangzhengyi

Lvtiansheng

2016/08/26

PART NO.

2008WRS-1xXX-XXXB05RRXXXQ

TITLE

Pitch 2,00 mm 90° SMT Wafer Connectors

UNIT

SCALE

SHEET

REV

NUMBER

mm

1:1

1/2

A0

A-000

DATE

1

REV

2

ECN NO.

DESCRIPTION

3

MODIFY

4

APPROVAL

5

APPROVAL

CHECK

DRAWN

DATE

Yangzhengguo

Yangzhengyi

Lvtiansheng

2016/08/26

PART NO.

2008WRS-1xXX-XXXB05RRXXXQ

TITLE

Pitch 2,00 mm 90° SMT Wafer Connectors

UNIT

SCALE

SHEET

REV

NUMBER

mm

1:1

1/2

A0

A-000

RoHS

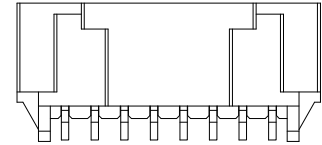
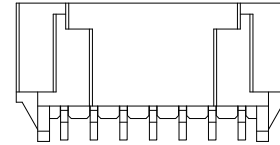
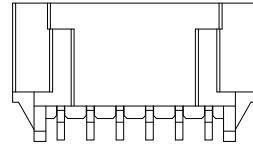
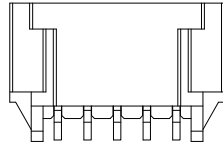
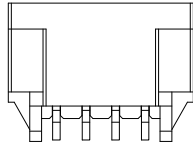
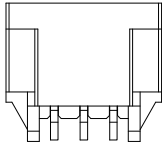
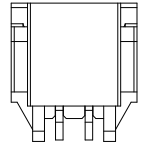
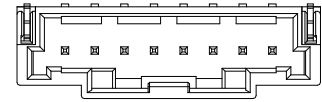
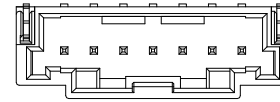
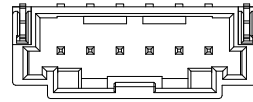
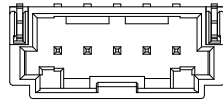
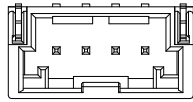
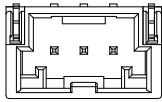
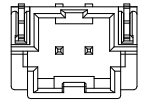

2pin

3pin

4pin

5pin

6pin

7pin

8pin

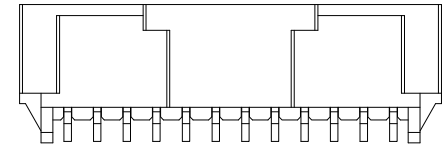
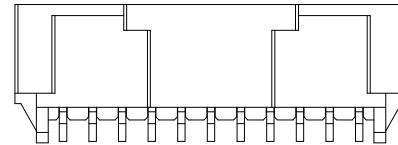
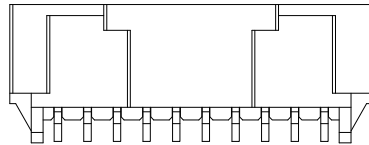
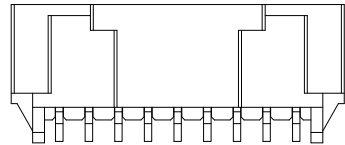
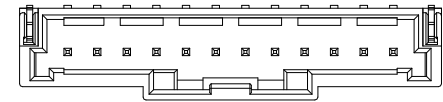
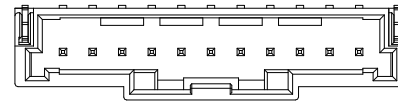
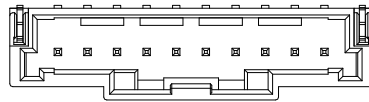
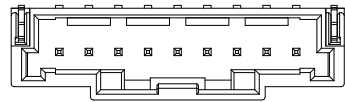

9pin

10pin

11pin

12pin

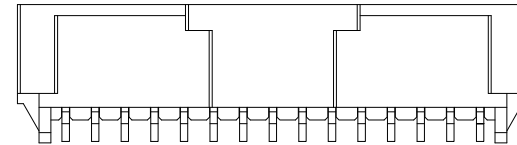
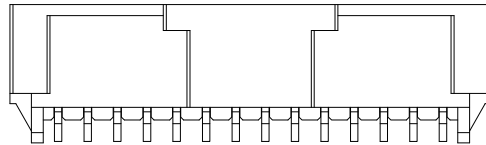
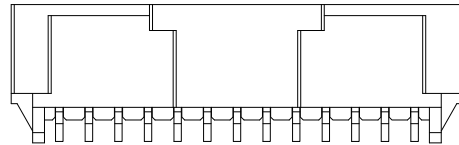
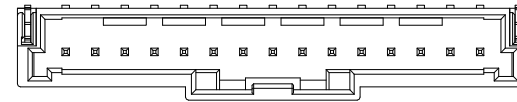
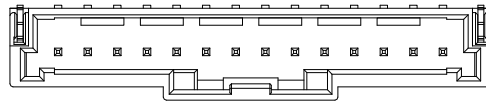
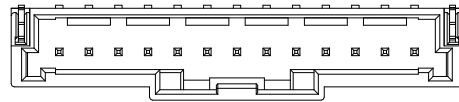

13pin

14pin

15pin



						GENERAL TOLERANCE	<div><div><div>GYA</div><div>Connectors</div></div><div>东莞市国亚电子有限公司</div><div>Dong Guan Guo Ya Connectors co.,ltd.</div></div>				PART NO.				
						.X ±0.30					2008WRS-1xXX-XXXB05RRXXXQ				
						.XX ±0.20					TITLE				
						.XXX ±0.10									
						X.° ±2°	APPROVAL	CHECK	DRAWN	DATE	Pitch 2,00 mm 90° SMT Wafer Connectors				
DATE	REV	ECN NO.	DESCRIPTION	MODIFY	APPROVAL	PROJECT	Yangzhengguo	Yangzhengyi	Lvtiansheng	2016/08/26	UNIT	SCALE	SHEET	REV	NUMBER
											mm	1:1	2/2	A0	A-000

RoHS

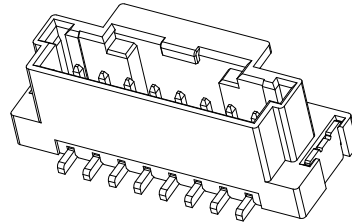

- Specifications :
- Voltage rating: 125V AC / DC
  - Current rating: 3A AC / DC
  - Withstanding voltage: 500V AC/minute
  - Temperature range: -40° ~+105°
  - Insulation resistance:  $\geq 1000M\Omega$
  - Contact resistance:  $\leq 10m\Omega$
  - After environmental testing:  $\leq 20m\Omega$
  - Material(Pin): Brass
  - Mates With GYA Housing : 2008H
  - "★" Critical dimension

2008 W V S - 1 x XX - XX X B XX X R XXX Q  
① ② ③ ④ ⑤ ⑥ ⑦ ⑧ ⑨ ⑩ ⑪ ⑫ ⑬

- ① Series No.  
② Category: W-wafer  
③ Connector Type: V-Straight 180°  
④ Mounting Type: S-SMT  
⑤ Row No.-Pin No: 1xXX-Single Row 1xXXPin  
⑥ Plastic material: 9T- PA9T 94V-0; LP- LCP 94V-0  
⑦ Color: N-Natural; B-Black; R-Red; L-Blue  
⑧ Metal material: B-Brass  
⑨ Plating Code: 05-Matte Tin  
30-Contact Area: Gold flash  
Solder Area: Matte Tin  
⑩ Packing: R-Reel ,Without Mylar  
⑪ RoHS/HF: R-RoHS H-Halogen-Free  
⑫ Sequence Number: 002-Coldsealing ; 02C-Heatsealing  
⑬ Special code :Q-Automotive Connectors

Poles	Dimensions (mm)					
	A	B	C	D	E	F
02	10.60	9.23	6.30	4.80	2.00	6.30
03	12.60	11.23	8.30	6.80	4.00	5.80
04	14.60	13.23	10.30	8.80	6.00	7.80
05	16.60	15.23	12.30	10.80	8.00	9.80
06	18.60	17.23	14.30	12.80	10.00	11.80
07	20.60	19.23	16.30	14.80	12.00	11.80
08	22.60	21.23	18.30	16.80	14.00	11.80
09	24.60	23.23	20.30	18.80	16.00	11.80
10	26.60	25.23	22.30	20.80	18.00	11.80
11	28.60	27.23	24.30	22.80	20.00	11.80
12	30.60	29.23	26.30	24.80	22.00	11.80
13	32.60	31.23	28.30	26.80	24.00	11.80
14	34.60	33.23	30.30	28.80	26.00	11.80
15	36.60	35.23	32.30	30.80	28.00	11.80

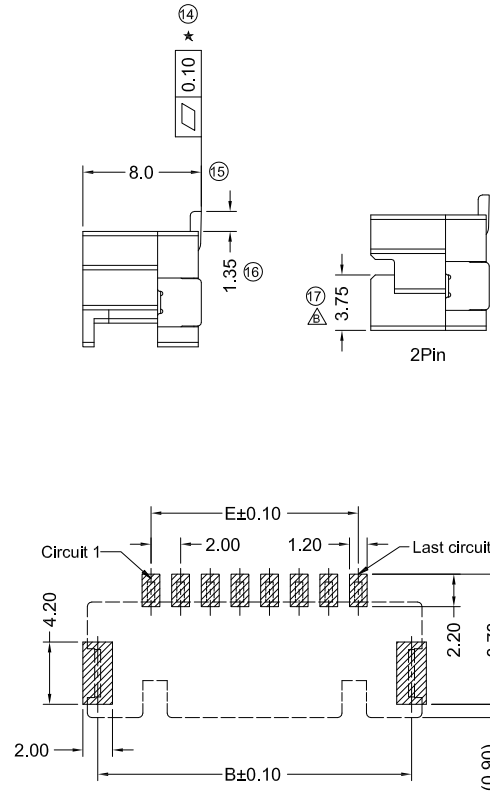

RECOMMENDED P.C.B LAYOUT  
(TOLERANCE:±0.05)

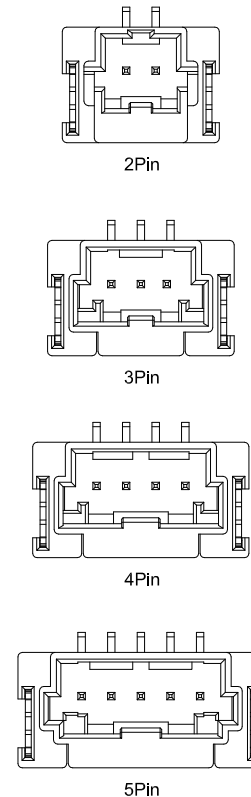

						GENERAL TOLERANCE	<div><div><div>GYA</div><div>Connectors</div></div><div>东莞市国亚电子有限公司 Dong Guan Guo Ya Connectors co., Ltd.</div></div>				PART NO. 2008WVS-1xXX-XXXBXXRRXXXQ				
						.X ±0.30					TITLE Pitch 2.00 mm 180° SMT Wafer Connectors				
						.XX ±0.20									
						.XXX ±0.10	APPROVAL	CHECK	DRAWN	DATE	UNIT	SCALE	SHEET	REV	NUMBER
						X.° ±2°									
DATE	REV	ECN NO.	DESCRIPTION	MODIFY	APPROVAL	PROJECT 	Yangzhengguo	Yangzhengyi	Lvtiansheng	2016/08/26	mm	1:1	1/2	A0	A-000

RoHS

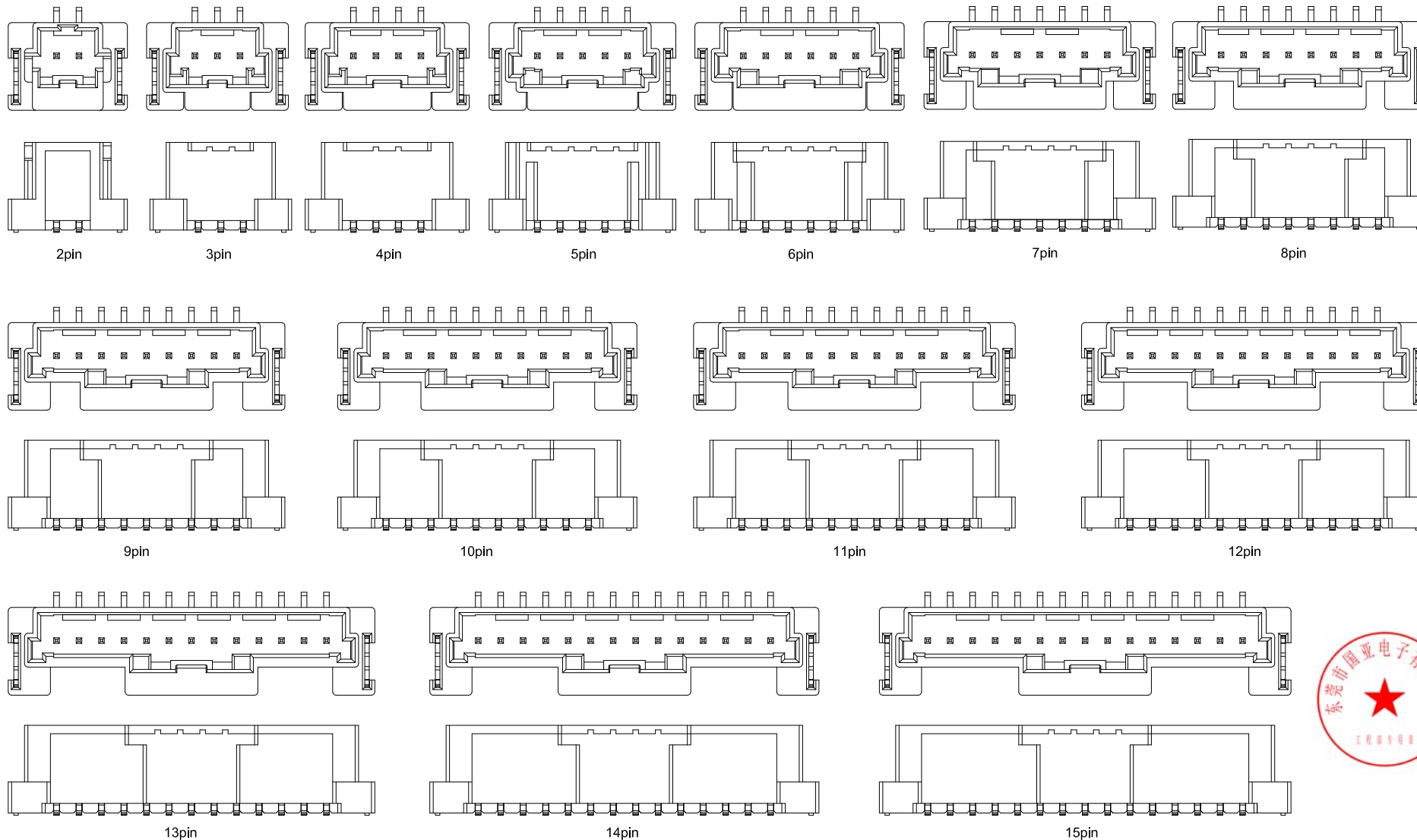

						GENERAL TOLERANCE	<div><div><div>GYA</div><div>Connectors</div></div><div>东莞市国亚电子有限公司</div><div>Dong Guan Guo Ya Connectors co., Ltd.</div></div>				PART NO. 2008WVS-1xx-XXXBXXRXXXQ				
						.X ±0.30					TITLE Pitch 2.00 mm 180° SMT Wafer Connectors				
						.XX ±0.20									
						.XXX ±0.10									
						X.° ±2°	APPROVAL	CHECK	DRAWN	DATE	UNITSCALESHEETREVNUMBER mm1:12/2A0A-000				
DATE	REV	ECN NO.	DESCRIPTION	MODIFY	APPROVAL	PROJECT 	Yangzhengguo	Yangzhengyi	Lvtiansheng	2016/08/26					
1		2		3		4		5		6		7		8	



RoHS

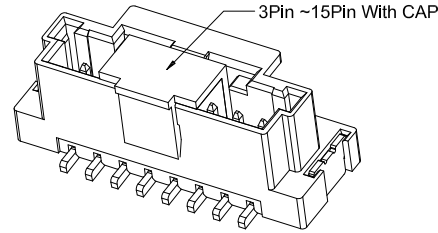

Specifications :

- Voltage rating: 125V AC / DC
- Current rating: 3A AC / DC
- Withstanding voltage: 500V AC/minute
- Temperature range: -40° ~+105°
- Insulation resistance:  $\geq 1000M\Omega$
- Contact resistance:  $\leq 10m\Omega$
- After environmental testing:  $\leq 20m\Omega$
- Material(Pin): Brass
- Mates With GYA Housing : 2008H
- "★" Critical dimension

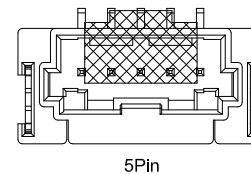
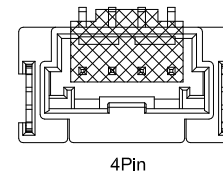
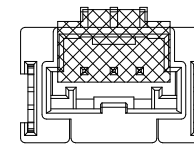
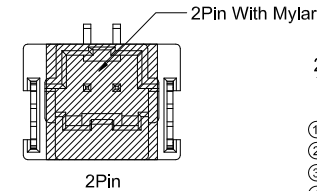
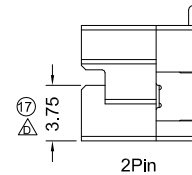
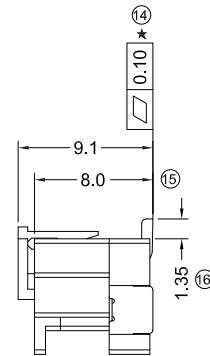
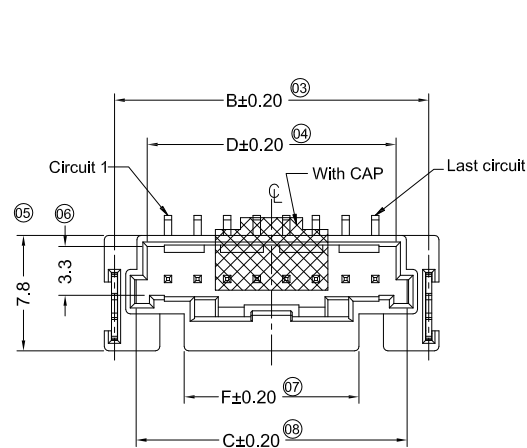
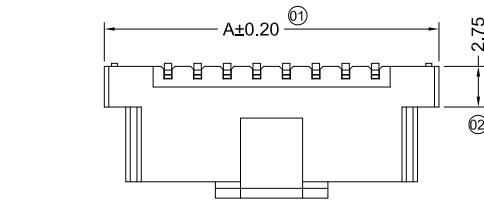

2008 W V S - 1 x XX - XX X B 05 X R XXX Q  
① ② ③ ④ ⑤ ⑥ ⑦ ⑧ ⑨ ⑩ ⑪ ⑫ ⑬

- ① Series No.  
② Category: W-wafer  
③ Connector Type: V-Straight 180°  
④ Mounting Type: S-SMT  
⑤ Row No.-Pin No Per Row: 1xXX-Single Row 1xXXPin  
⑥ Plastic material: 9T- PA9T 94V-0; LP- LCP 94V-0  
⑦ Color: N-Natural; B-Black; R-Red; L-Blue  
⑧ Metal material: B-Brass  
⑨ Plating Code: 05-Matte Tin  
⑩ Packing: W-Reel , With Mylar  
C-Reel , With CAP  
⑪ RoHS/HF: R-RoHS H-Halogen-Free  
⑫ Sequence Number: 002-Coldsealing ; 02C-Heatsealing  
⑬ Special code :Q-Automotive Connectors

Poles	Dimensions (mm)					
	A	B	C	D	E	F
02	10.60	9.23	6.30	4.80	2.00	6.30
03	12.60	11.23	8.30	6.80	4.00	5.80
04	14.60	13.23	10.30	8.80	6.00	7.80
05	16.60	15.23	12.30	10.80	8.00	9.80
06	18.60	17.23	14.30	12.80	10.00	11.80
07	20.60	19.23	16.30	14.80	12.00	11.80
08	22.60	21.23	18.30	16.80	14.00	11.80
09	24.60	23.23	20.30	18.80	16.00	11.80
10	26.60	25.23	22.30	20.80	18.00	11.80
11	28.60	27.23	24.30	22.80	20.00	11.80
12	30.60	29.23	26.30	24.80	22.00	11.80
13	32.60	31.23	28.30	26.80	24.00	11.80
14	34.60	33.23	30.30	28.80	26.00	11.80
15	36.60	35.23	32.30	30.80	28.00	11.80

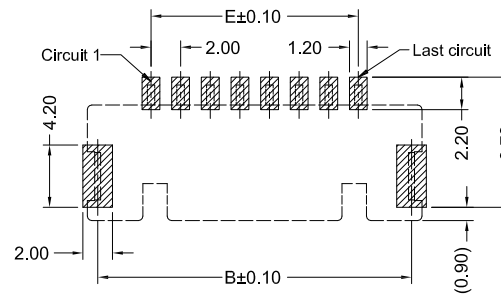

RECOMMENDED P.C.B LAYOUT  
(TOLERANCE:±0.05)

GENERAL TOLERANCE

.X ±0.30  
.XX ±0.20  
.XXX ±0.10  
X.° ±2°

PROJECT

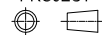

东莞市国亚电子有限公司  
Dong Guan Guo Ya Connectors co., Ltd.

APPROVAL

CHECK

DRAWN

DATE

Yangzhengguo

Yangzhengyi

Lvtiansheng

2016/08/26

PART NO.

2008WVS-1xXX-XXXB05XRXXXQ

TITLE

Pitch 2.00 mm 180° SMT Wafer Connectors

UNIT	SCALE	SHEET	REV	NUMBER
mm	1:1	1/2	A0	A-000

DATE REV ECN NO. DESCRIPTION MODIFY APPROVAL

RoHS

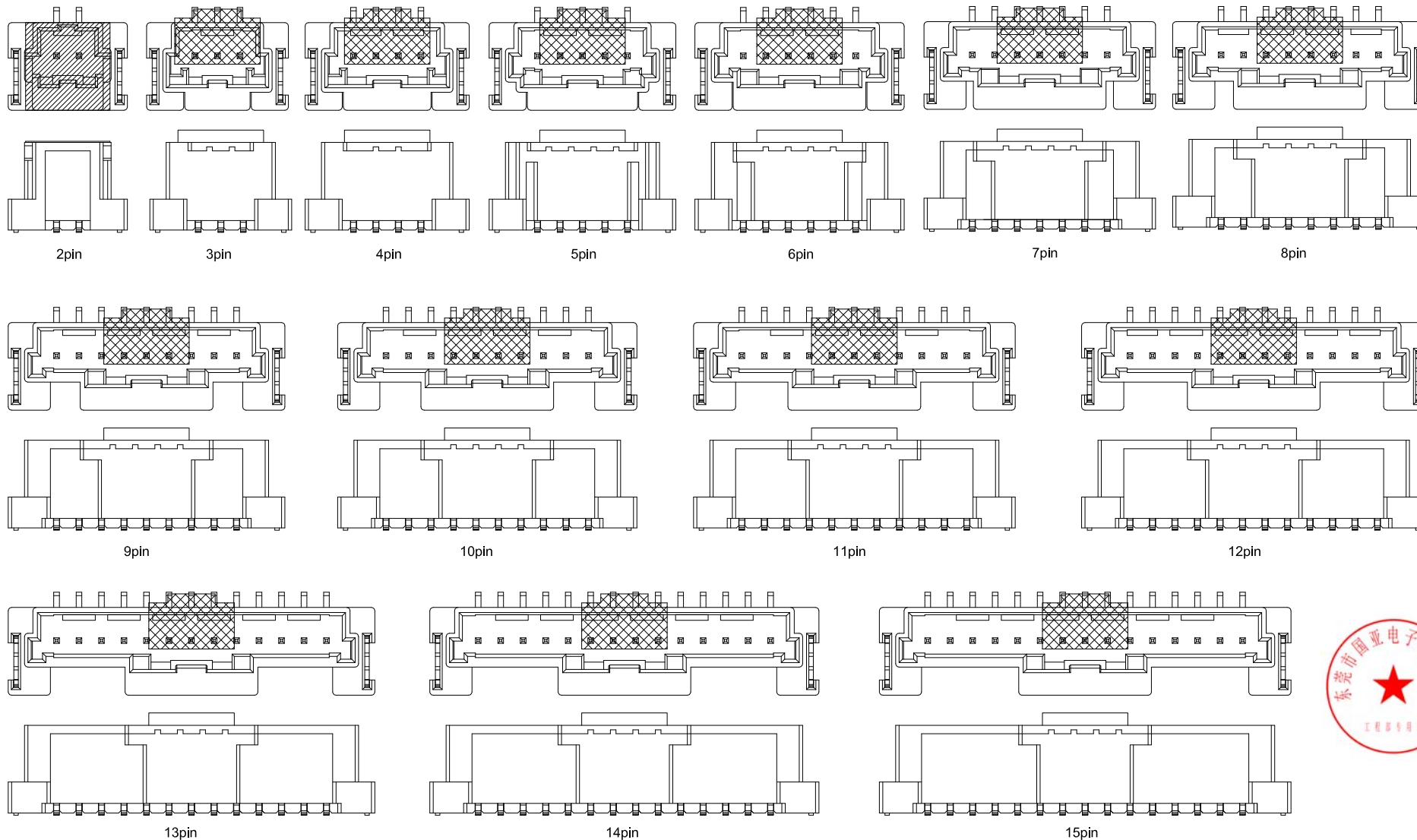

						GENERAL TOLERANCE	<div><div>GYA</div><div>Connectors</div></div> <div>东莞市国亚电子有限公司</div> <div>Dong Guan Guo Ya Connectors co., ltd.</div>				PART NO.					
						.X ±0.30					2008WVS-1xXX-XXXB05XRXXXQ					
						.XX ±0.20					TITLE					
						.XXX ±0.10										
						X.° ±2°	APPROVAL	CHECK	DRAWN	DATE	Pitch 2.00 mm 180° SMT Wafer Connectors					
						PROJECT		Yangzhengguo	Yangzhengyi	Lvtiansheng	2016/08/26	UNIT	SCALE	SHEET	REV	NUMBER
DATE	REV	ECN NO.	DESCRIPTION	MODIFY	APPROVAL	mm						1:1	2/2	A0	A-000	